

DEVELOPED BY



An Urban Life-Style

In the heart of Durgapur.



For more information Call +91 9953004827
Mail: contact@basantaenclave.com
www.basantaenclave.com

Office Address: B-28, Nandalal Bithi, City Center, Dgp-16.
Site Address : RD-24, Bhiringee, Benachity, Dgp-13.

Disclaimers: All information, images and visuals, designs and drawings, plans or sketches are only representative, an architects impression or artistic renderings and not to scale. Nothing contained herein intends to constitute a legal offer and does not form part of any legally binding agreement. Recipients / viewers are advised to exercise their discretion in relying on the information provided and are requested to verify all the details, specifications including areas, amenities and facilities, services, payment plans and other relevant terms independently with the promoter (N.N Construction), have thorough understanding of the same and take appropriate advice prior to concluding any decision for buying the project. *Taxes and statutory charges extra as applicable and terms and conditions apply.



Gaze at the manicured gardens; enjoy with family at the pool or party with friends at the clubhouse...



BASANTA
— ENCLAVE —

Makes For A Luxurious Urban Lifestyle Like No Other.

03 Towers | **94** Apartments | **08** PentHouses

One Lifestyle

Keeping Connectivity at the heart

Rising in the bustling heart of Bhiringi, Basanta Enclave epitomizes all the advantages of an urban residence, and yet there is more to it. Connected to the major hubs of the city via arterial roads and NH, just 200 mtrs, this is one spot on the map that makes connecting the dots seamless and simple.

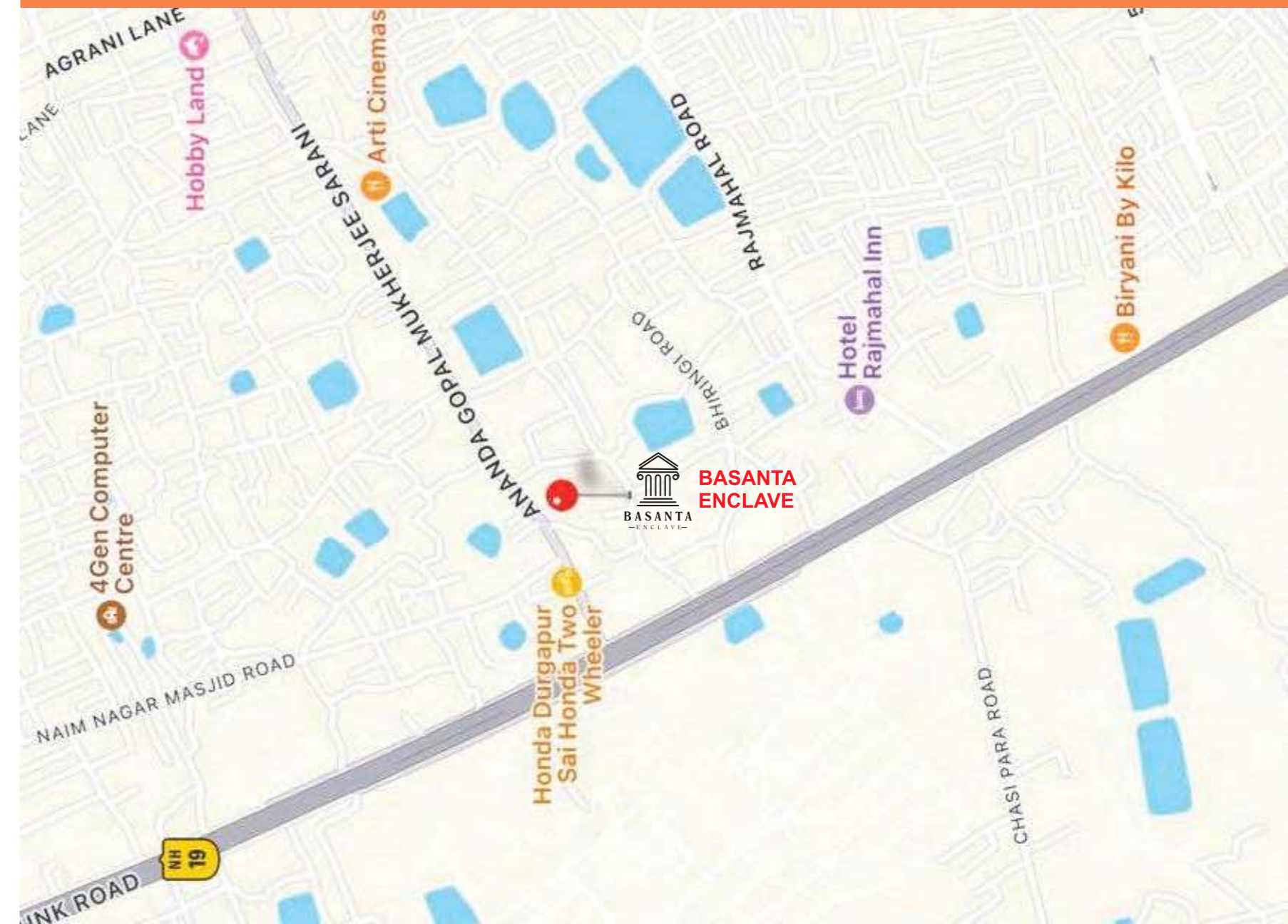

1. KNI Airport	2.5 km
2. Benachity Bazar	200 m
3. Shiv Shakti Dham	1.5 km
4. City Centre Bus Stand	3 km
5. Durgapur Railway Station	8 km
6. The Mission Hospital	10 km
7. Health World Hospital	3 km
8. Delhi Public School	11 km
9. Guru Teg Bahadur Public School	2.5 km
10. DAV Model School	4.6 km

Apartment Interiors
**MOVE INTO
OPULENCE**

Each of the 94 apartment and 8 penthouses is created for a connoisseur. Available in 2 and 3 bedroom apartments, they are thoughtfully designed to ensure a life of seamless convenience. Few interior design specimen have been aesthetically done for the better understanding:



Life At The Top

Exclusive Pent Houses 2600 sq ft)



LIVING ROOM



OPEN KITCHEN



DINING AREA



OPEN TERRACE

Happily Ever After Begins Here State-of-the-art Club House

Designed for a Self Sufficient Lifestyle: Basanta Enclave is at the centre of a healthy, active lifestyle. Essentials that enrich the daily life of residents can be found at the exclusive state-of-the-art Clubhouse - covered swimming pool along with a kids pool, a full fledged gymnasium, Yoga Room, Library, TT- Table and a floor exclusively for the Banquet Hall.



SITE LAYOUT



SITE PLAN
SCALE-1:200

Technical & Apartment Specification

Living/Dining/BedRooms

- **Floor:** Tiles (Johnson/AGL or Equivalent)
- **Wall :** Wall Putty and Primer(Berger)
- **Ceiling :** Putty and Primer(Berger)

Kitchen

- Floor: Antiskid Tiles
- Wall : Putty and Primer
- Counter: Stone Counter (Tiles upto 2 ft above the counter top)
- Fittings and Fixtures: SS Sink and CP Fittings.

Toilet

- **Floor:** Antiskid Tiles
- **Wall :** Tiles upto 6ft
- **Ceiling:** Putty and Primer
- **Fittings and Fixtures:** CP fittings, wash basin and EWC (Jaquer or equivalent)

Balcony

- **Floor:** Vitrified Tiles
- **Wall:** Exterior paint
- **Railing:** SS/MS Designed Railing upto 4ft High

Doors

- **Main Door:** Decorative Flush Door
- **Internal Doors:** Normal Flush Door

Window / External Glazing

- Single glazed units with aluminium frames and shutters (wherever applicable)

Electrical Fixtures and Fittings

- Modular Switches (Anchor or Equivalent)
- Internal Wirings: Havells
- Video Door Bell at the Main Apartment Door.

Fire Fighting System

Disclaimer: Specifications as mentioned are subject to marginal variations, which may be necessary during construction. The brands of the equipment / appliances / goods and the specifications and facilities mentioned may change on account of non-availability thereof.

FLOOR PLAN



Block 1 (1st - 4th Floor)

FLOOR PLAN



Block 1 PentHouses (5th Floor)

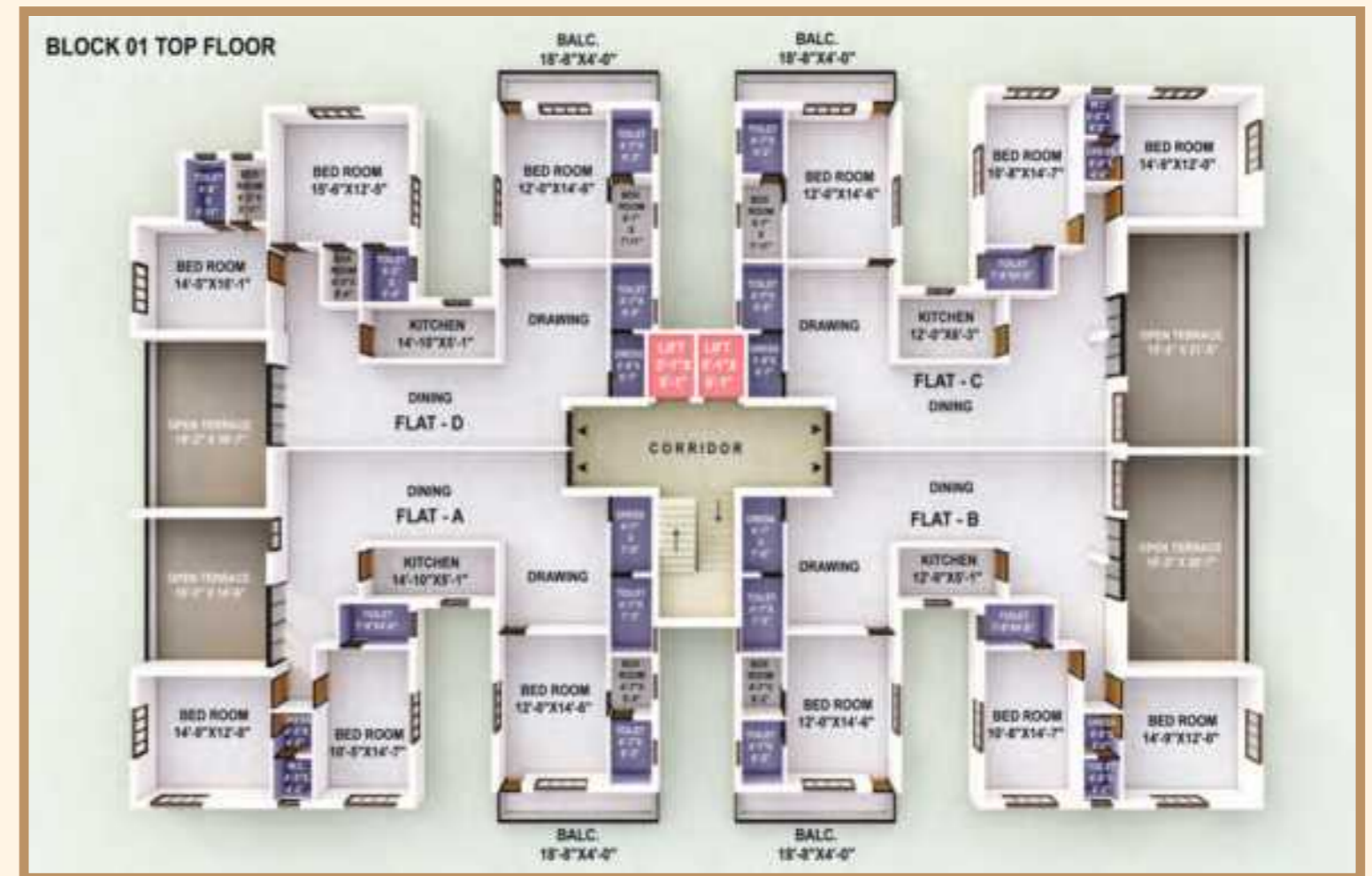

Block 2 (1st to 5th Floor)



Block 2 (1st to 5th Floor)

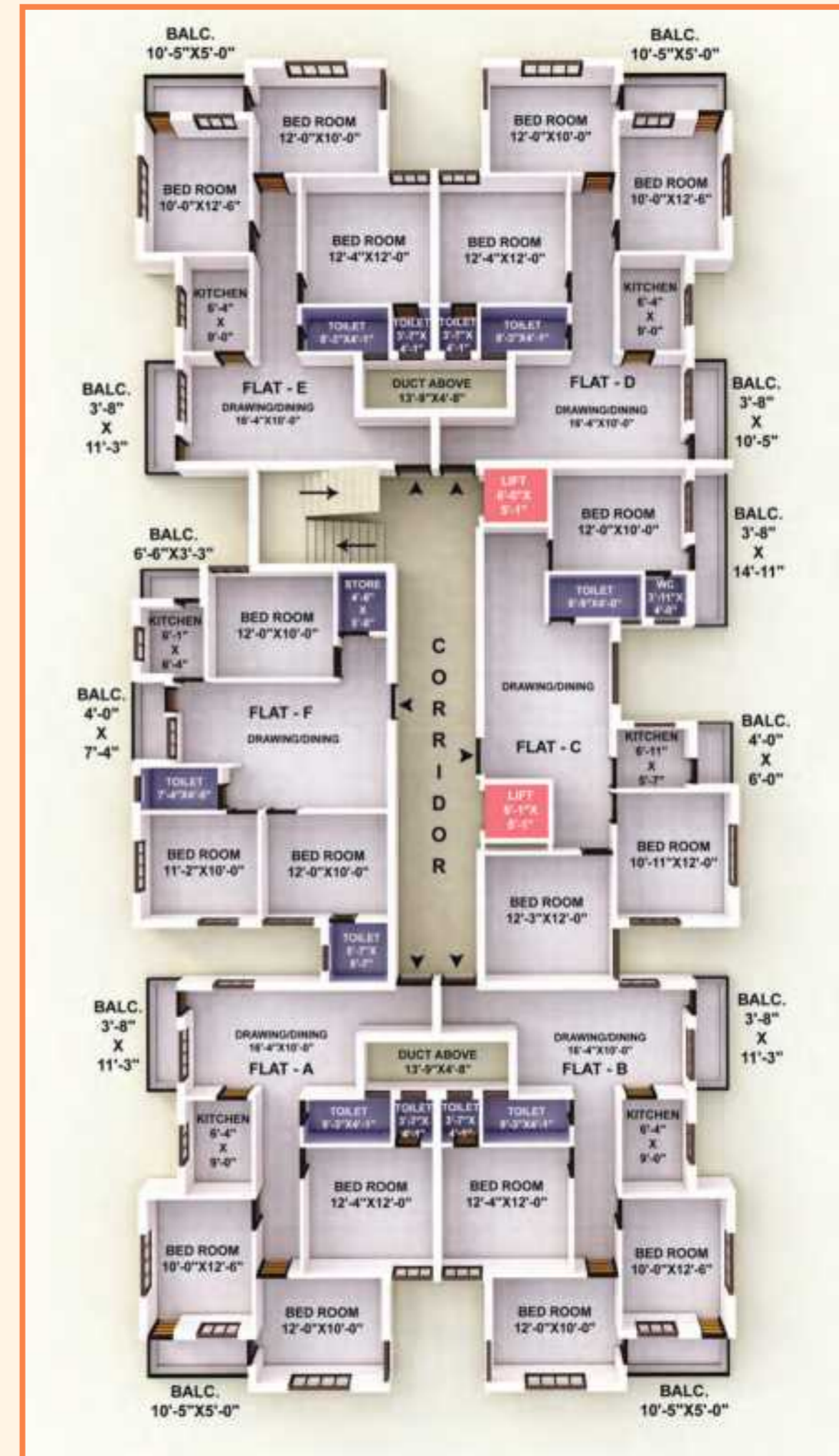



Block 3 (1st to 4th Floor)



Block 3 Penthouses (5th Floor)

